



## ABLUTION UNIT



河南坤宏钢结构有限公司  
HENAN K-HOME STEEL STRUCTURE CO., LTD



## ABOUT US

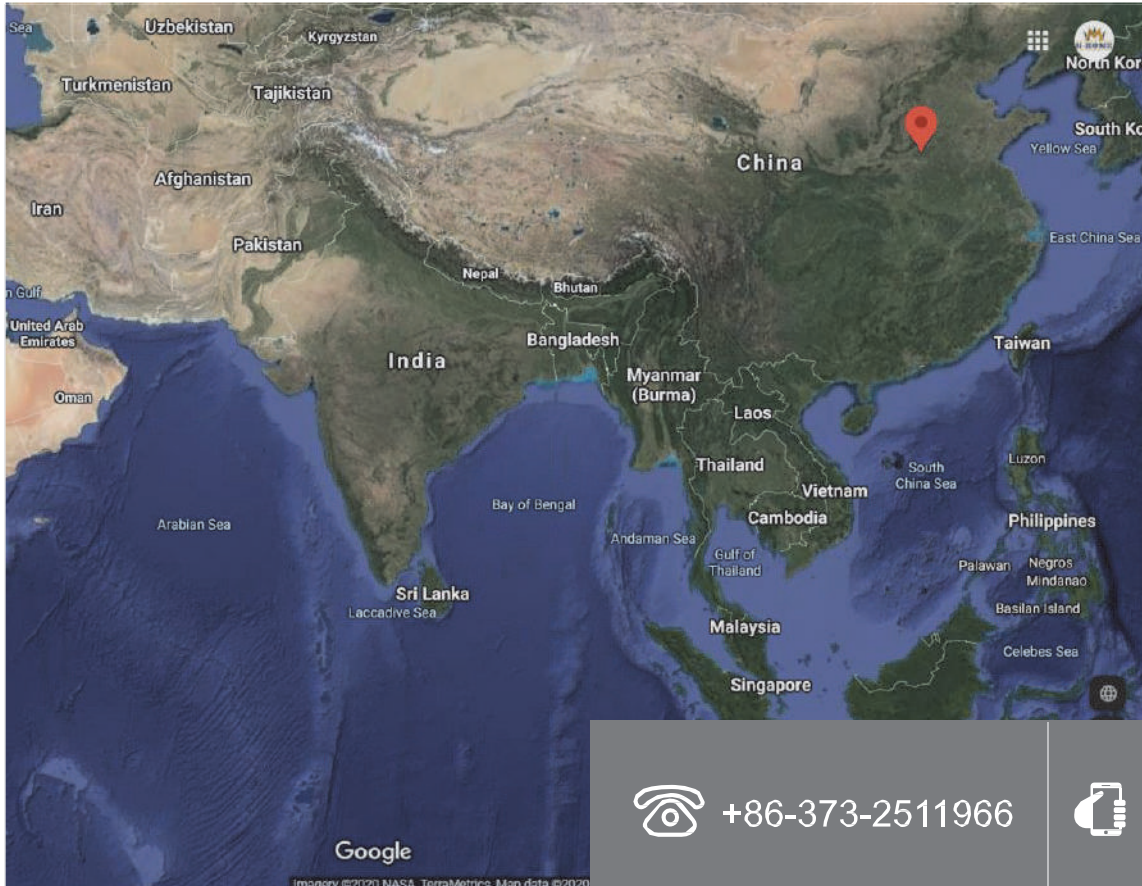

### HENAN K-HOME STEEL STRUCTURE CO., LTD

Henan K-home Steel Structure Co., Ltd is located in Xinxiang, Henan Province. It is a self operating private enterprise, established in the year of 2015. We are engaged in design, project budget, fabrication, installation of steel structure and sandwich panels with 4<sup>th</sup> generation steel frame.

As a result of our high quality products and outstanding customer service, we have gained a global sales network reaching (Philippines, Singapore, Kenya, Nigeria, Spain, Mali, Somalia, Iceland, etc.)...

 Xiaodian Industrial Park, Xinxiang City, Henan Province, China



+86-373-2511966



+86-18790630368



info@khomehina.com

## MODULAR PREFAB ABLUTION BLOCKS

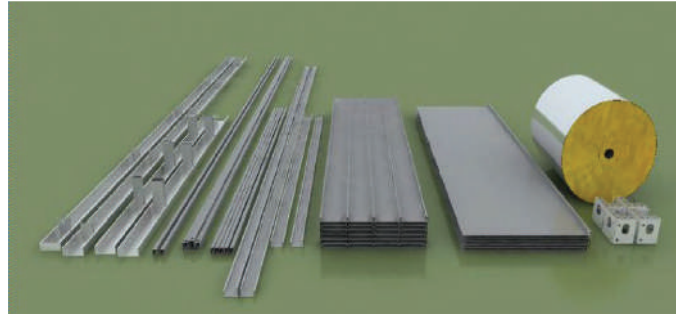
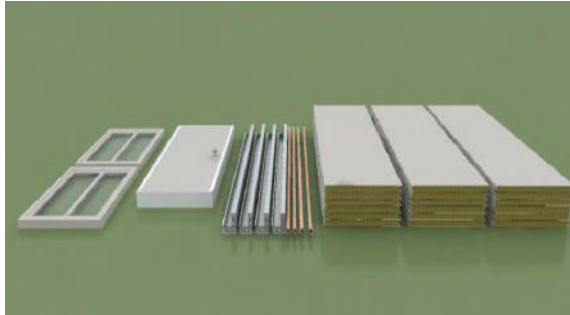

### About Ablution Block

The ablution block is a movable and customizable container structure, which is widely used in various industries, organizations, offices and provides public facilities for areas lacking toilets. Ablution Block is a modular restroom which can be easily and quickly assembled and disassembled with a container house as the main body. The ablution container toilet can be moved anywhere according to visitors and changes in the construction site. It has the advantages of strong adaptability, strong creativity, low carbon, environmental protection, convenient movement, and high safety services. The container ablution toilet can be fitted with hygienic treatment plan that can be used temporarily for a short period of time or in remote areas. No matter whether you need a prefab ablution block in the crowded city center, or at your construction site, so matter the size, we can all customize it for you.

## ABLUTION BLOCKS DESIGN



Container ablation block design is an innovative site solution that uses the steel structure and portability of the container to ablation facilities. As a public restroom design, the container toilet block can be an independent module building, or it can be used as part of the prefab container office building or container dormitory building. Here are some commonly used designs of container ablation blocks. The modular ablation block uses the steel structure as the main structure to ensure stability and service life. Set up multiple independent compartments in the men's and women's partitions, equipped with basic facilities such as toilet, urinal, washbasin, and shower.

To ensure ventilation and lighting, a sufficient amount of windows are designed to introduce natural light and fresh air to improve the lighting and ventilation effects of the restroom. It is recommended that you install the exhaust fan to ensure the circulation of air in the bathroom and reduce the smell and humidity.



## ABLUTION BLOCK CONTAINER



The standard size of the detachable container ablution unit, flat pack containers and folding container unit comes in various sizes. Due to the structure of its screw connection, it can easily expand from the four sides, and the internal layout is very flexible. No matter what you want, toilet seats, urinal, washbasins, shower rooms, etc. Our ablution block is very flexible. You can choose to bury the sewage pipes under the ground, or you can use the steps to cover the pipeline for the waste management.

### Some of our Designs

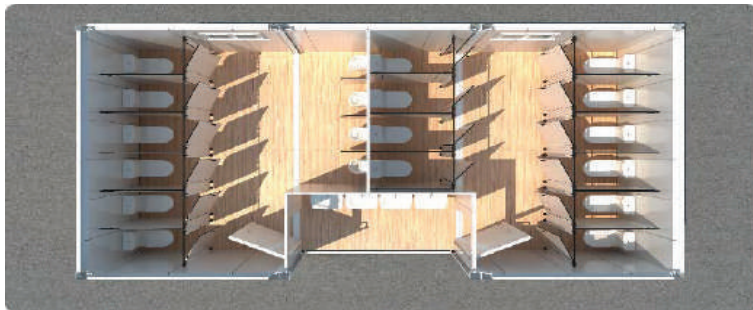
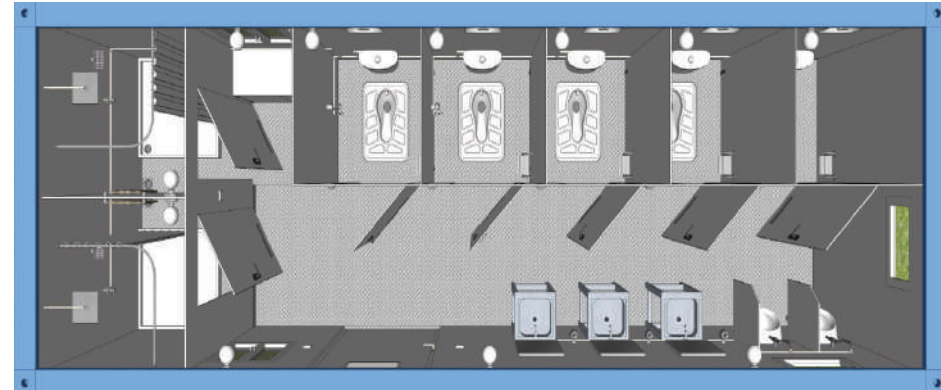
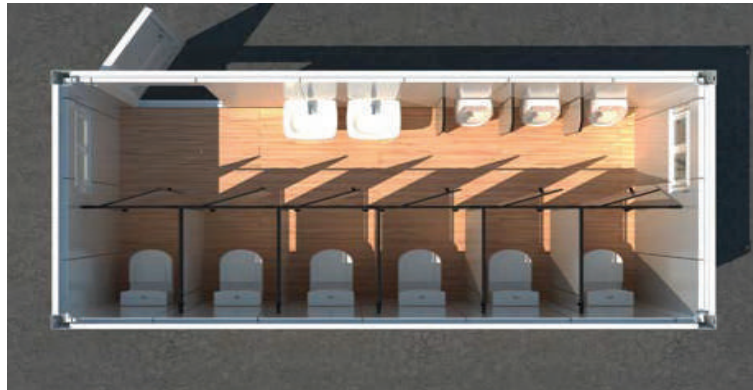

## ABLUTION UNIT FACILITIES BENEFITS



Model : KHCH

### KEY HIGHLIGHTS



- Portable , easy to use , convenient to clean, requires small area.
- Suitable for various humid and corrosive environments.
- Smooth surface, easy to clean and maintain.
- Fireproof, waterproof, heatproof, heat insulation, light weight sandwich panel supported by galvanized coated steel sheet.
- 4<sup>th</sup> generation steel frame.
- Ablution unit can be easily fixed & dismantable.
- Convenient to use among 50 people.
- Beautiful appearance, green environmental protection.

# ABLUTION UNIT

## General Technical Specifications

### Construction:

Ablution construction is based on structural calculations and architectural design, with crane hinges positioned on top.

### Dimensions (mm):

7000 mm x 2400 mm x 2600 mm (l x b x h)

### Steel frame:

4<sup>th</sup> generation steel frame (increased bottom purlin, corner joints interface increased, improved water gutter, added downpipe, increased sealing strips).

### Outer and Inner layer of Ablution wall

- The outer and inner layer of ablution walls are constructed using 50 mm thick fireproof, waterproof, heatproof, light weight sandwich panel featuring inner and outer layers made from 0.4 mm thick galvanized coated steel sheet.
- Engineered to withstand strong winds, heavy rain, and intense sunlight even in extreme weather conditions.
- Have proper arrangement facility of ventilation, windows, and exhaust fan.



Figure 1 : Ablution Unit

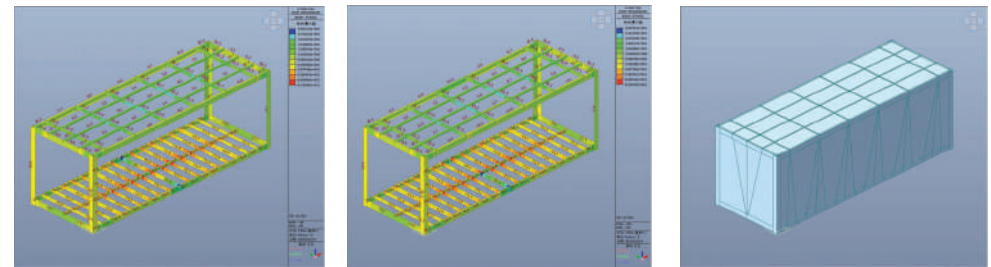

Figure 2 : Structural Calculations

## ABLUTION UNIT

### General Technical Specifications

#### Wall insulation:

- 50 mm rock wool panel.
- Designed to withstand heat. Rock wool insulation is applied to handle high temperatures up to 55°C effectively.

#### Floor covering:

- Galvanized steel frame are used for the construction of the base and U section frames are used to cover the flooring.
- 18 mm fiber cement board + 2 mm corrugated aluminum sheet + 150 microns PVC transparent sheet.

#### Roof:

- The roof is constructed using suitable galvanized steel frames covered with 75 mm thick glass wool insulation and galvanized
- U-Frames are used to drain water from corners of the columns. The Proper water drainage system is provided by fitting 4 PVC pipes in each 4<sup>th</sup> generation steel frame columns.

#### Gutter:

Improved water gutter with water drainage system from PVC pipes.

#### Inner partition:

12 mm thick compact laminated partition wall with all necessary fittings.

#### Windows and Door:

1 (Main door)+ 5 (Toilet doors)+ 2( Shower doors).  
2 Windows .

#### Water Storage:

2000 L fresh water high density water tank fitted with 0.5 hp water lift pump.

#### Others:

Includes PVC plumbing pipes, electrical sockets, light switches, indoor and outdoor lighting facility, cable harness and all other necessary standard accessories with complete ablution unit setup according to International Standard .



## INNER FITTINGS



### Toilets and Urinals

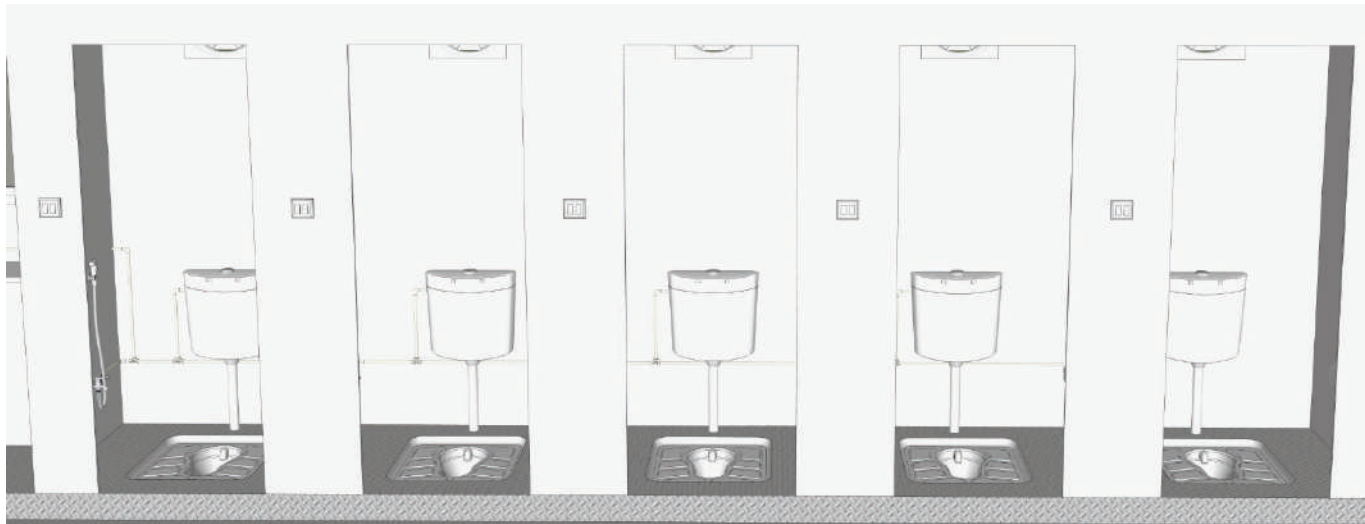

*Figure 3: Pan Based Toilets*



*Figure 4: Urinals*

- Equipped with ceramic pan based toilets and urinals, each with cistern and water flushing provisions.
- Have 5 numbers of pan based toilets and 2 urinals.
- One tap, one spray jet, and one toilet paper inside each unit with proper flush system arrangement for each unit of toilet.
- Includes 6 exhaust fans, light switches, indoor lights facility, and other required accessories.
- Includes all necessary fittings set required for the complete toilet and urinal area setup.

## INNER FITTINGS

### Shower Area

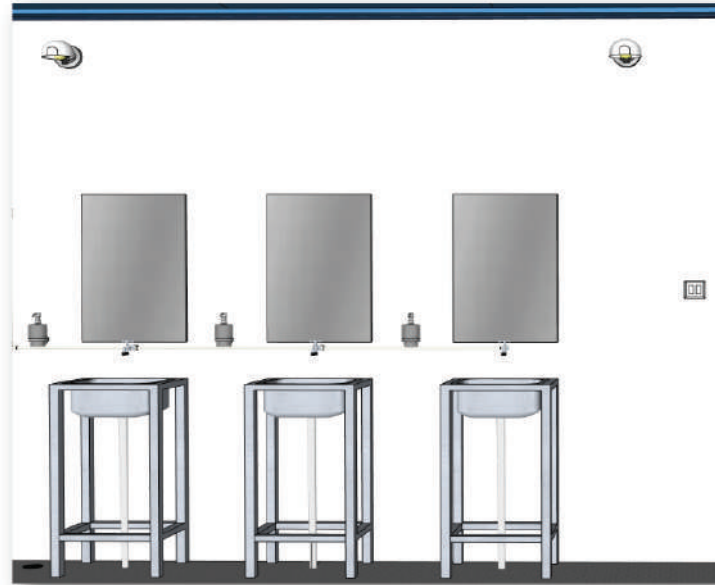

*Figure 5 : Shower Area*

- Have two spacious shower areas, each designed to offer maximum comfort and privacy.
- Equipped with stainless steel shower head (20 x 20 cm) with a tap on the wall.
- Includes a soap dish holder, towel hook, indoor lights facility, and other required accessories.
- Equipped with PVC pan closet which collects and directs water to the drain, complemented by a curtain for added privacy.
- Includes all necessary fittings set required for the complete shower area setup

## INNER FITTINGS

### Wash Basin



*Figure 6: Wash Basin*

- 3 wash basins are included which can comfortably accommodate 3 people in the wash basin area.
- Features 3 stainless steel wash basins each equipped with a faucet, mirror, soap dish holder, indoor lights facility and other required accessories.
- Includes all necessary fittings set required for the complete wash basin area setup.

## Water Pump



These water pumps are used to lift the fresh water from the source to the water tank.

These pumps are Reliable, economical, and simple to use, they are suitable for domestic applications and the automatic distribution of water from surge tanks, watering gardens, lifting water to the tank and for boosting insufficient mains water pressure.

These pumps should be installed in a covered area, protected against the weather.

### Technical Data

Model :	QB60
Power :	0.5 HP (0.37 KW)
H.max :	38 m
Q. max :	35 L/ min
Size :	1"x1" (inch)
S.head :	8 m
Speed :	2850 rpm



*Model QB60 Water Pump*



# DISMANTTABLE FEATURES OF ABLUTION UNIT

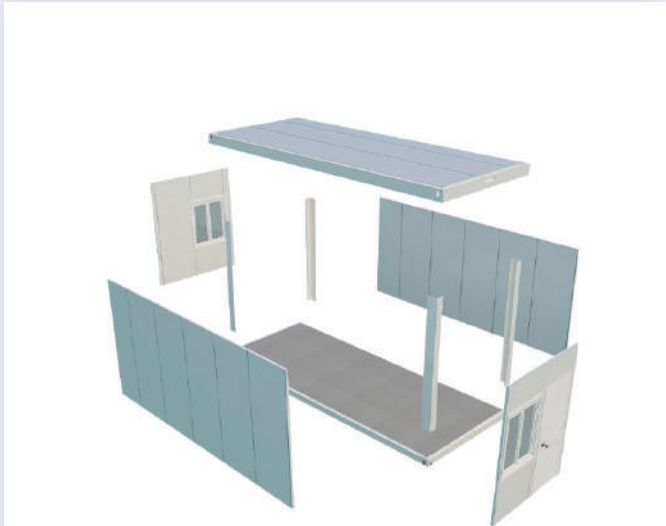
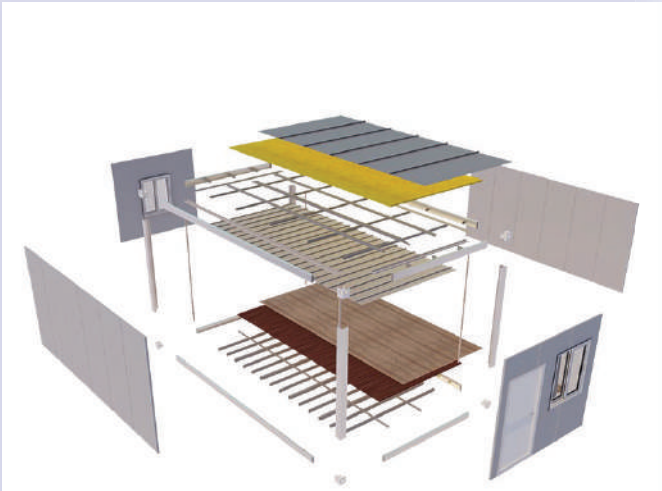

Designed for easy dismantling and offers a practical solution/mobility for transporting our whole designed abluion unit without any hassle.



# UPGRADE BRING YOU A BETTER EXPERIENCE

## 4<sup>th</sup> Generation Galvanized Steel Frame

Increased Bottom Purlin

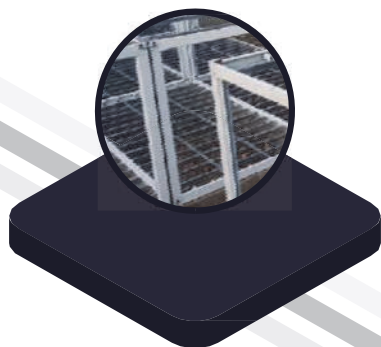

Corner Joints  
Interface Increased

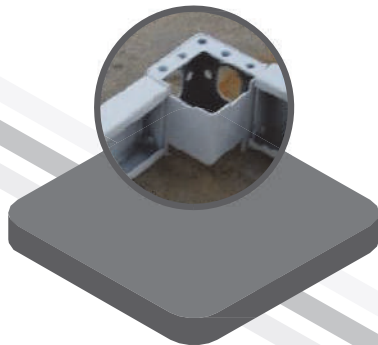

Improved Water Gutter

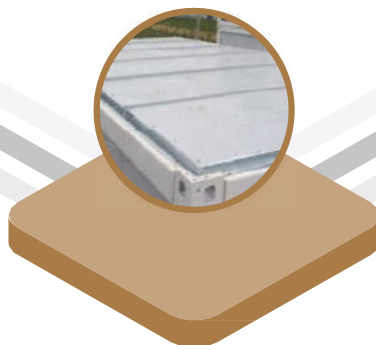

Added Downpipe

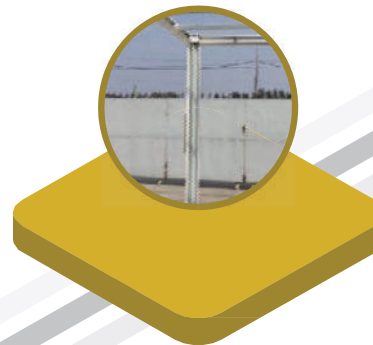

Increased Sealing Strips

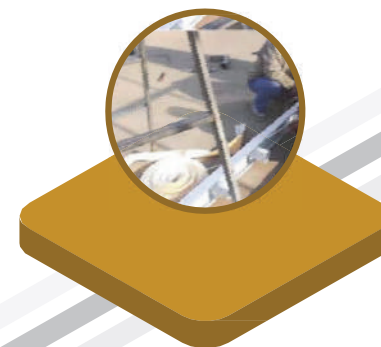

## UPGRADE OF THE PURLINS NUMBER AND SIZE



The previous generation of Ablution unit only had 9 direction purlins at the bottom with no extra support at the bottom. Now, our bottom purlin has been upgraded to 14 short Direction purlins. We have also reinforced the long direction.

In addition to upgrading the number of vertical and horizontal purlins, we also increased the size of the purlins. The size of the commonly used purlin is 40\*80\*2960 mm. We upgraded 4 of them to 80\*80\*2960 mm purlin to ensure better stability and durability.

## UPGRADE OF THE CORNER JOINTS



The number of bolt holes for the Corner Joints connection has been upgraded to 9. There are 8 bolt holes for the previous generation product.



## UPGRADE OF RAINWATER TREATMENT SYSTEM

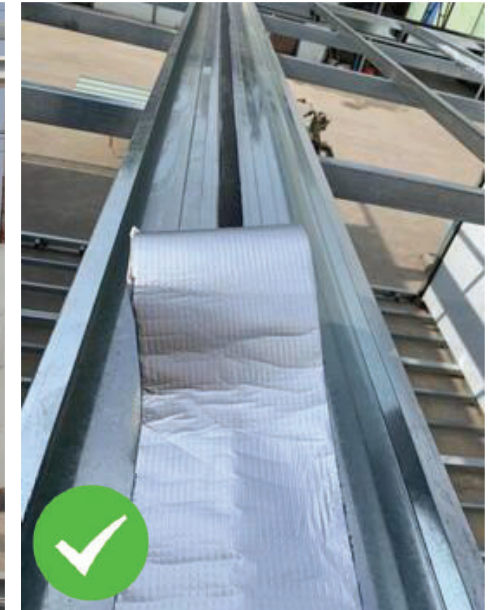
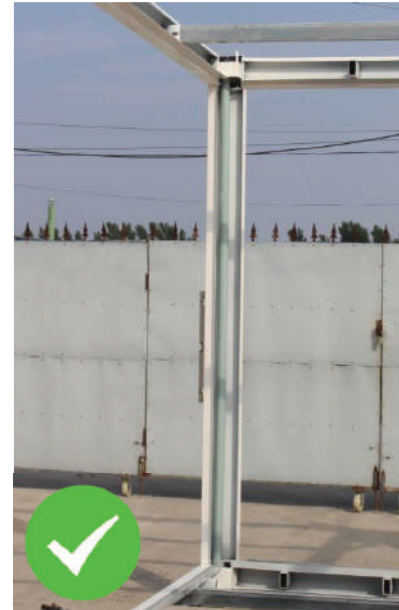
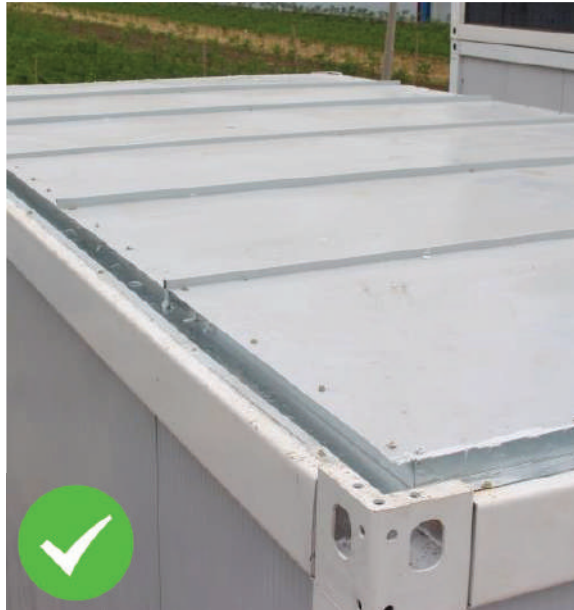
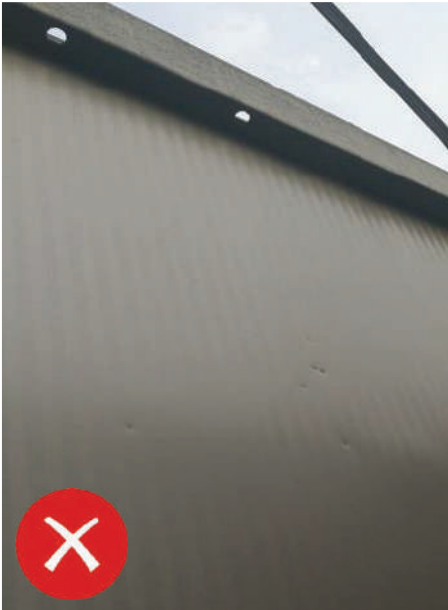

Big water gutter for roof structure. Even for heavy rain, abluion unit will be very water-proof.

Updated drainage system is more durable. We modified the water drain system, each column are designed and equipped with 4 water drain pipes.

Can easily solve the problem of rainwater infiltration with butyl tape. We use butyl tape at the junction of two container abluion unit; to extend the service life.

## ABLUTION UNIT INSTALLATION SOLUTION

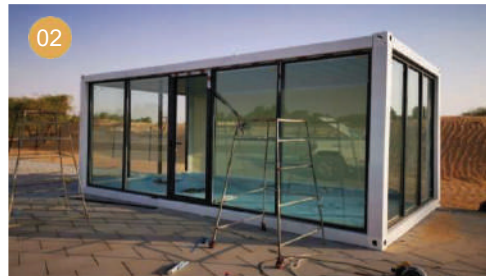

Our container abluition unit have lower geological requirements. According to clients project situation, we will give corresponding suggestions. Here are some situations for your reference:

- 01 - Place directly on the concrete floor.
- 02 - Place directly on other stable ground like brick floor.
- 03 - Use brick and cement for the bottom pillar.



# TRANSPORTATION & PACKING



■ **GET IN  
TOUCH  
WITH US**

 EMAIL: [info@khomechina.com](mailto:info@khomechina.com)

 TEL & FAX: +86 373-2511966

 WEB: [www.khomechina.com](http://www.khomechina.com)

 ADD: Xinxiang, Henan Province, China